

WHAT YOU NEED

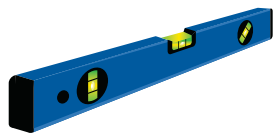

2 - 4



LEVEL



TAPE

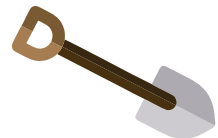

SPADE

KIT CONTENTS

PARTS NOT TO SCALE

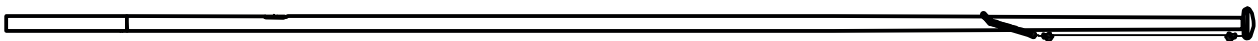

FLAG POLE WITH PRE-ASSEMBLED GROUND TUBE x1
(ACCESS KEY AFFIXED TO TOP CAP)



FLAGS CAN BE PURCHASED SEPARATELY FROM ABEL



IMPORTANT! YOU MUST SURVEY THE GROUND FOR EXISTENCE OF ANY UNDERGROUND SERVICES, CALL BEFORE YOU DIG.

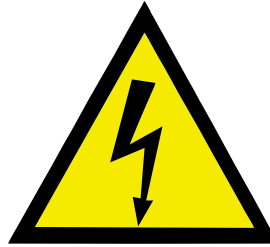

1

FOUNDATION LAYOUT FOR FLAG POLE

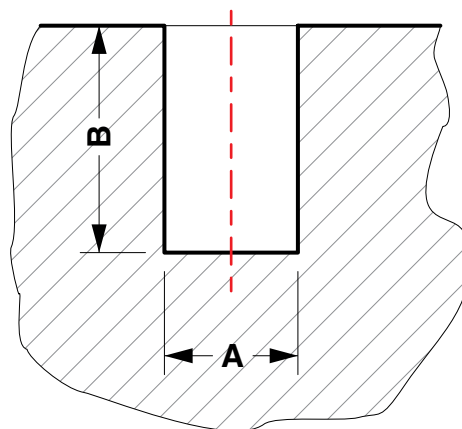

2

FOUNDATION SIZE TABLE

MODEL	A (mm)	B (mm)	CONCRETE BAGS	Est Concrete (m ²)
UTVR-2-6	450	700	6	0.1
TVR-2-6	450	700	6	0.1
UTVR-2-7.5	450	800	7-8	0.2
TVR-2-7.5	450	800	7-8	0.2
TVR-2-8	450	900	8-9	0.2
TVR-2-9	600	1000	12	0.3
TVR-2-10	600	1100	Sureset only	0.3
TVR-2-12	800	1300	Sureset only	0.6

CONCRETE RECOMMENDATIONS:
 MINIMUM STRENGTH:
 25MPA 80-100 SLUMP
 20-25 AGGREGATE
 ADDITION OF 2%
 CONCRETE
 ACCELERATOR

3

LAYOUT POLE IN FRONT OF THE FOUNDATION HOLE

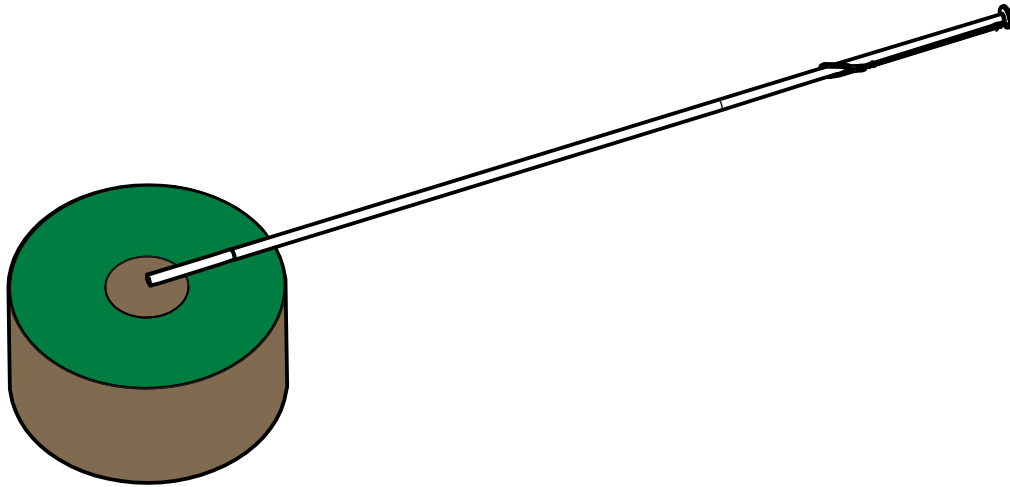

4

STAND POST WITH ATTACHED GROUND TUBE IN HOLE, POSITION, LEVEL AND STABILISE POLE READY FOR CONCRETE POUR

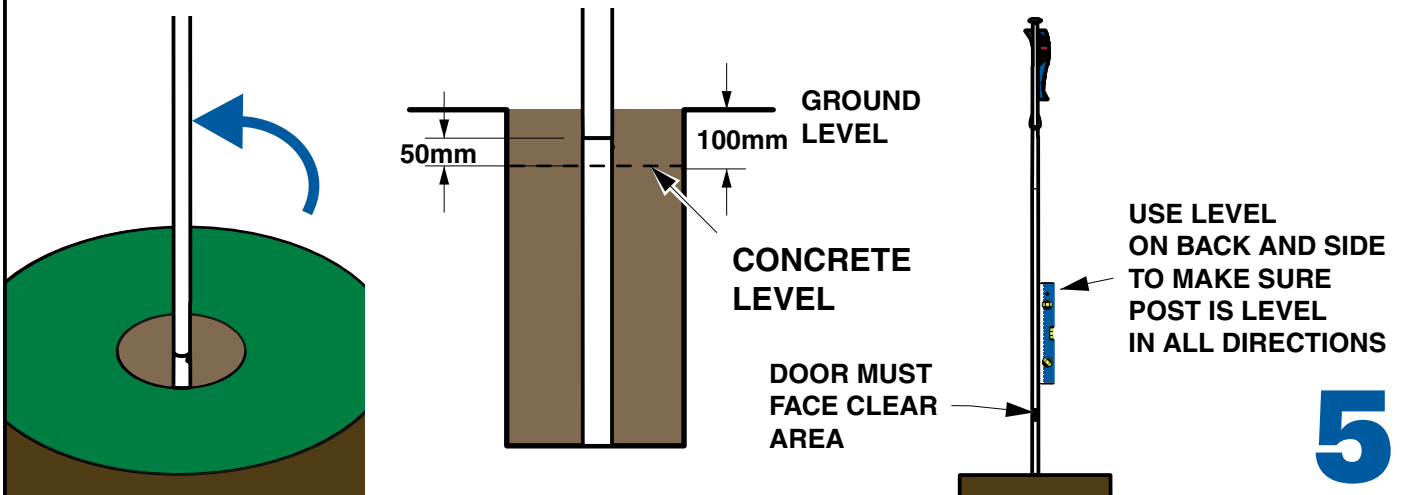

5

ONCE YOU HAVE POSITIONED THE POLE, POUR CONCRETE 100mm BELOW GROUND LEVEL

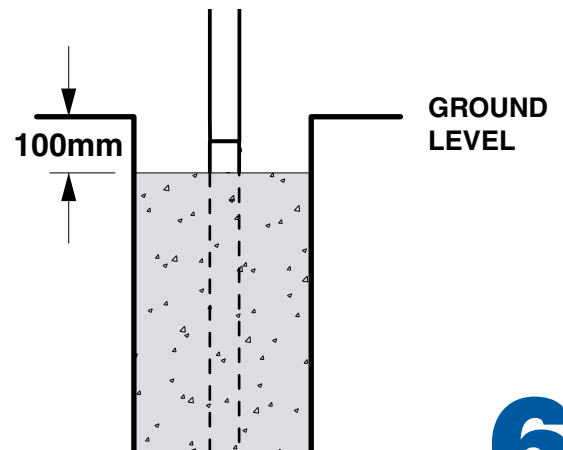

6

CONCRETE RECOMMENDATIONS:

MINIMUM STRENGTH: 25MPA 80-100 SLUMP 20-25

AGGREGATE. ADDITION OF 2% CONCRETE ACCELERATOR

OPEN DOOR IN POLE, UNCLIP AND LOWER HALYARD (ROPE), UNTIL THE FLAG WEIGHT IS LOW ENOUGH TO ATTACH THE FLAG

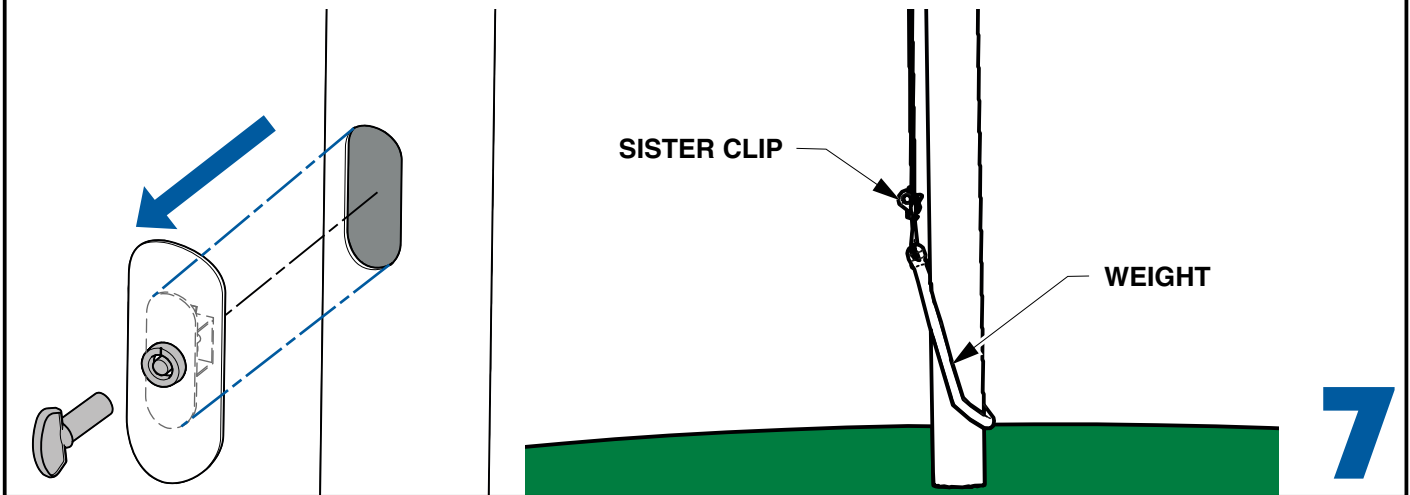

CONNECT SISTER CLIPS TOGETHER, ADJUST UPPER SISTER CLIP ON THE HALYARD (ROPE) SO THAT THE FLAG IS TAUT AND ROPE IS SLACK

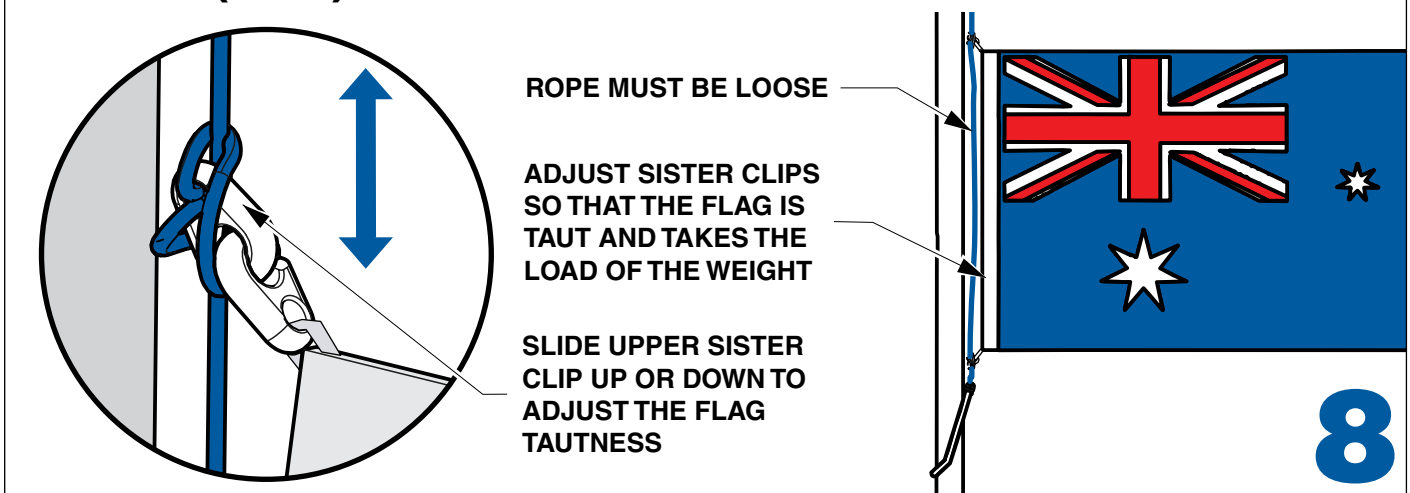

RAISE FLAG BY PULLING THE ROPE WITHIN THE ACCESS DOOR, USE THE ROPE LOCKING CLEAT INSIDE THE POLE TO HOLD THE ROPE IN PLACE,

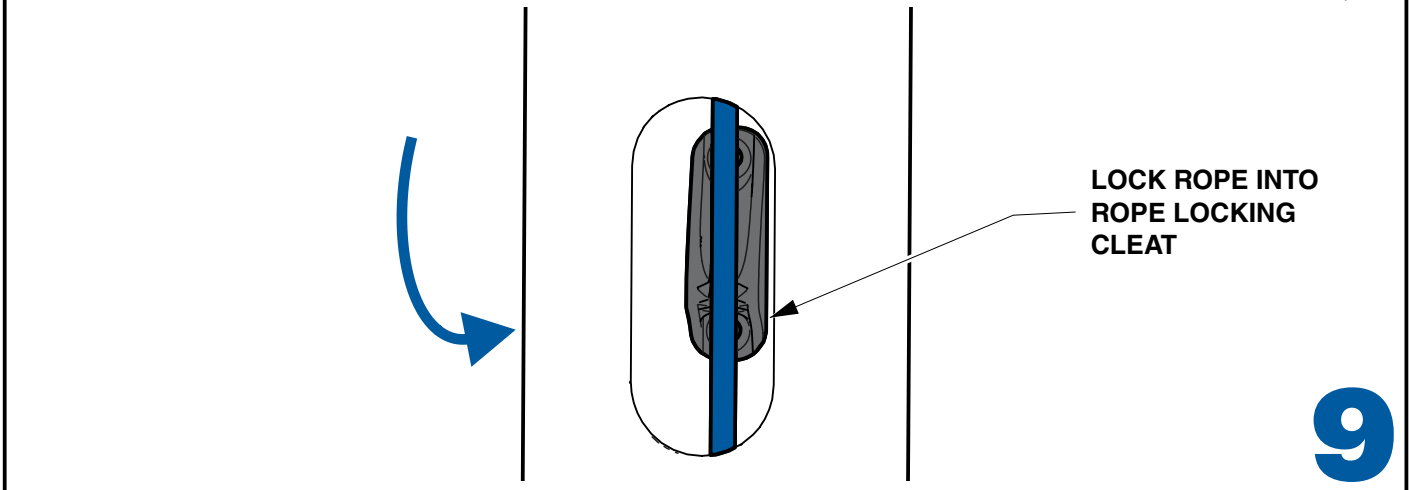

THE REMAINDER OF THE ROPE MUST BE PLACED INSIDE THE POLE AND CLEAR OF THE DOOR, RELOCATE THE ACCESS DOOR AND LOCK IN PLACE

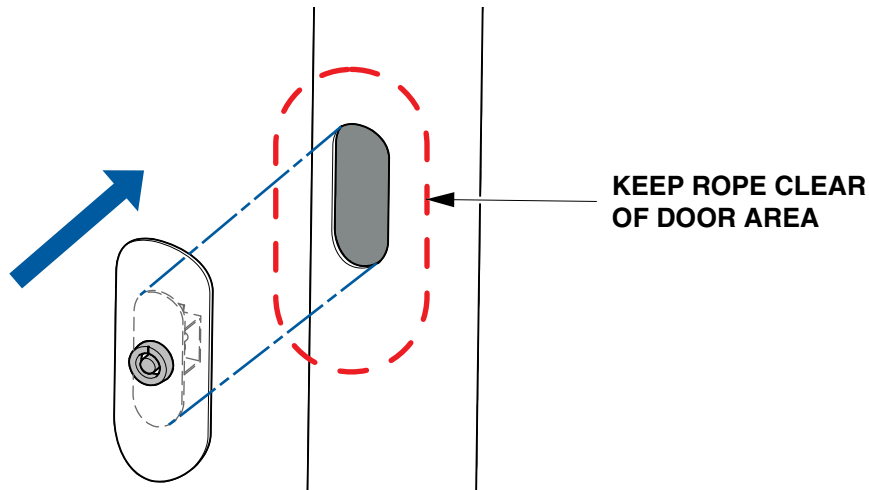

10

CHECK THE CONDITION OF THE ROPE AND FLAG, AND ADJUST THE UPPER SISTER CLIP AS NECESSARY EVERY 6 MONTHS

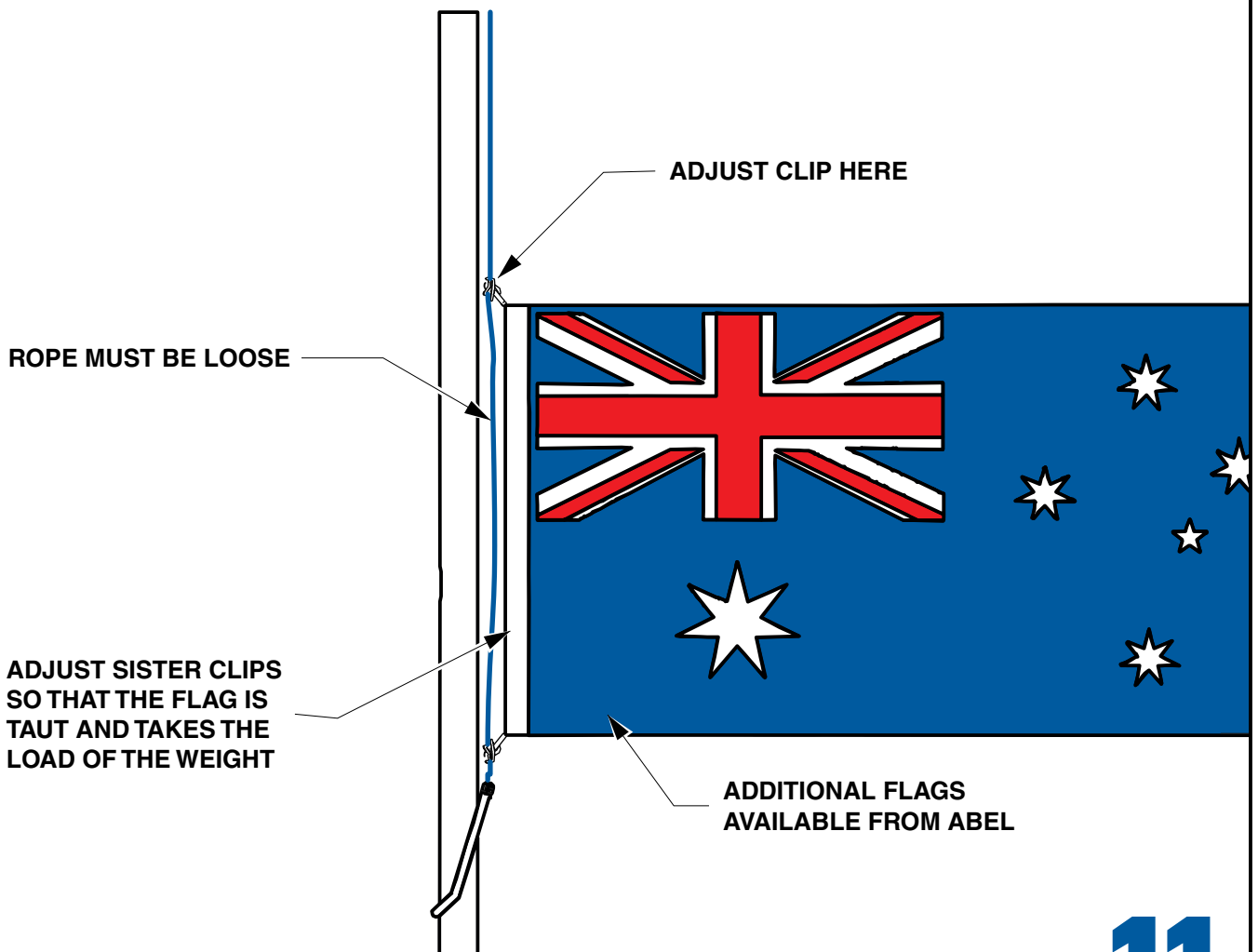

11